

Professional Use Line Laser

VLM-635/650-37 Series



FEATURES:

- Professional Red Line Laser.
- The supreme line-accuracy and the widest emitting angle line Laser module for use with Professional applications.
- Versatile mechanical structure on 4 sides, easy to fixed.
- This module has integrated quartz cylindrical lens, collimating lens, laser diode, and APC driver circuit.
- APC driver circuit enables the Laser output power safe and constant.
- Aluminum housing with Anodized finish for the best heat transfer consideration .
- Utilize Glass Lens, spot-size maintain tight-dot while temperature fluctuate between -20°C ~50°C.
- Dimensions: (W)14 x (H)14 x (L)26 mm, (W 0.551" x H 0.551" x H 1.023")
- Wavelength : 635 / 650 nm
- Output power (Center/Total) : Class II – less than 1mW / 2~12mW
- Laser line accuracy: 20" (+/- 1mm @10m).
- Emitting angle: > 120°
- 2.6~5 VDC operation.
- Connection type: Lead wire

APPLICATIONS:

- Professional Red Straight Line Laser, ultra-precision grade for professional leveling, alignment, adjusting, positioning, measuring and targeting device.
- Wood processing.
- Metal processing.
- Stone processing.
- Textile industry.
- Food industry.
- Automotive industry.
- Medical science

VLM-635/650-37 Series

OUTLINE DIMENSIONS (UNITS: mm)

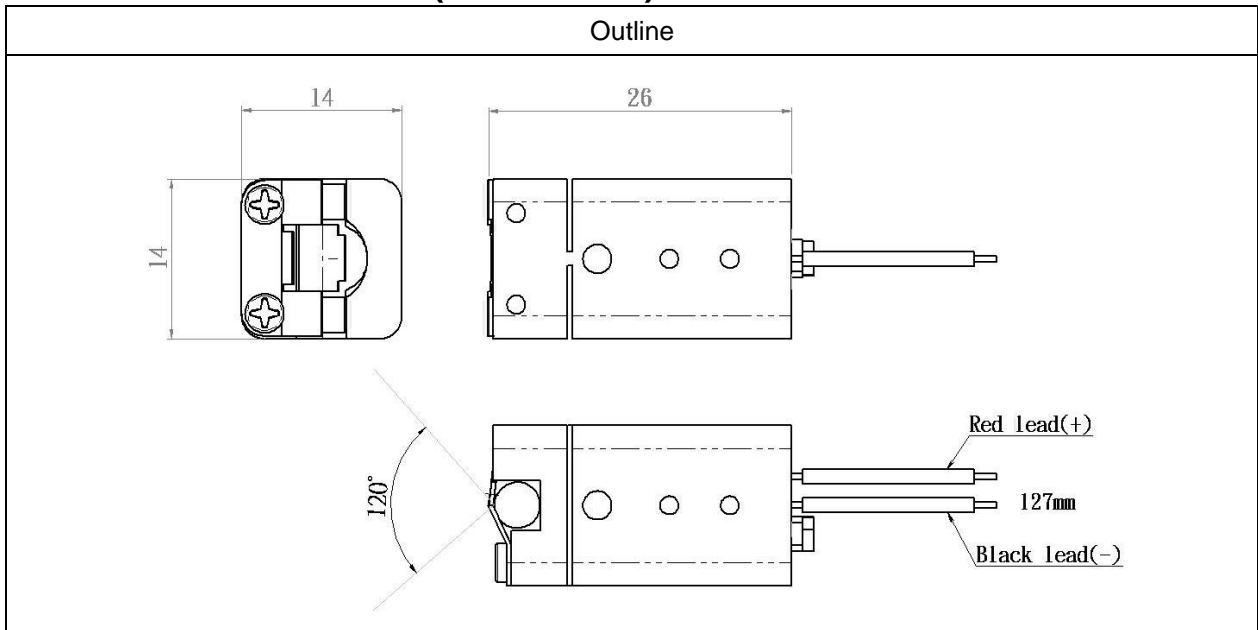

SPECIFICATIONS

SPECIFICATIONS		635-37 LPT	650-37 LPT	650-37 LPT-30
1	Dimensions	(W)14 x (H)14 x (L)26 mm (W 0.551" x H 0.551" x H 1.023")		
2	Weight	11g		
3	Operating voltage (Vop)	2.6~5 VDC		
4	Operating current (Iop)	< 50mA	< 35mA	< 100mA
5	Continuous wave output power (Center)	<1mW		
6	Continuous wave output power (Total)	2mW	2mW	12mW
7	Wavelength at peak emission (λ_p)	630~645nm	645~665nm	
8	Cylindrical lens	Quartz cylindrical lens (ϕ 4)		
9	Collimating lens	Glass lens(ϕ 7)		
10	Beam Shape	Line		
11	Laser line Width	2 \pm 1mm @5m, 4 \pm 1mm @10m		
12	Laser line accuracy	20" (+/- 1mm @10m)		
13	Emitting angle	> 120°		
14	Operating temp. range	-20°C ~+50°C		
15	Storage temp. range	-40°C ~+70°C		
16	Housing Material	Aluminum		
17	Housing Color	Black		



18	Potential of Housing	Insulated	
19	Wire Type	UL1007-26AWG	
20	Cable length	127mm	
21	Mean time to failure (MTTF) 25°C	5000hrs	10000hrs

Note : Laser module housing is an electrical positive surface, it is imperative that contact between the laser module and the machine be avoided. This is to prevent damage from the machine electrical leakage. Surge protected power supply to the laser module is strongly recommended.

VLM-635/650-37 Series

ORDER CODE

Order Code	Wavelength	Total Output Power	Connection Type
VLM-635-37 LPT	635 nm	2 mW	Lead Wire
VLM-650-37 LPT	650 nm	2 mW	Lead Wire
VLM-650-37 LPT-30	650 nm	12 mW	Lead Wire

SAFETY LABEL

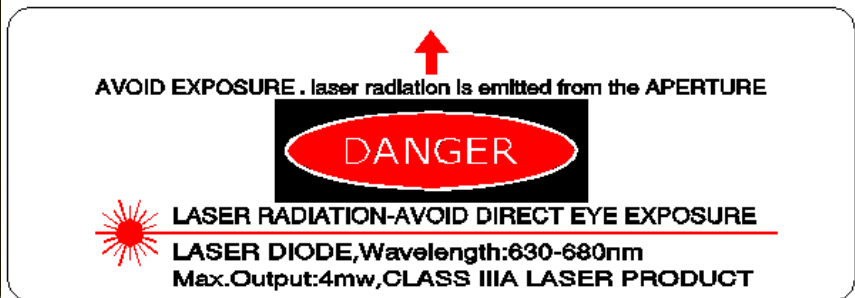

Annex A.

Laser Line Accuracy

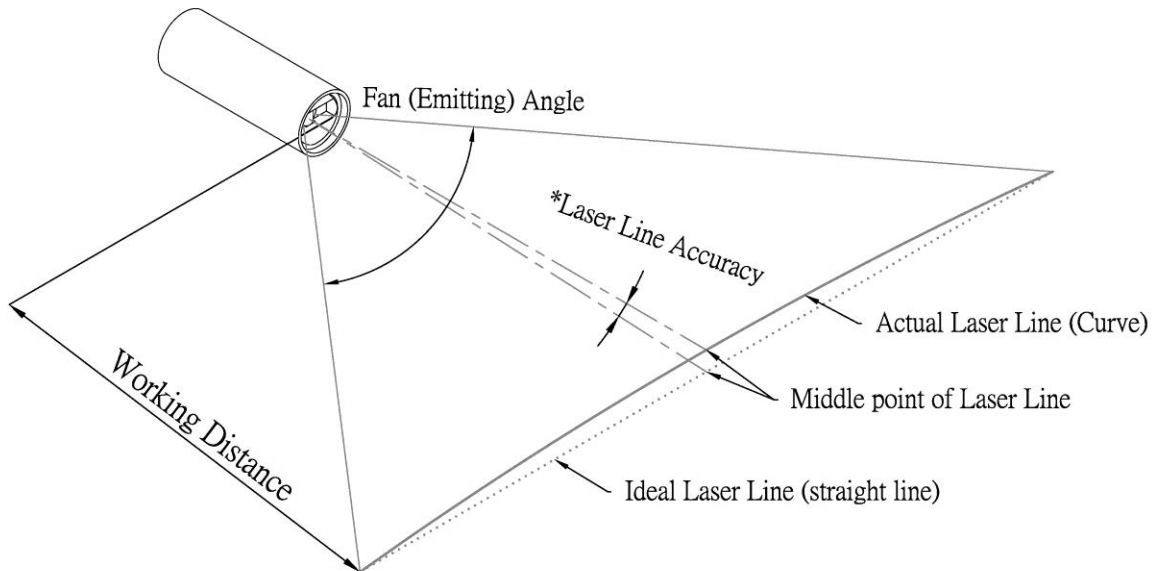

*Laser Line Accuracy

The error angle between Ideal and Actual Laser Line at middle point.

For VLM-635/650-27 Series, Laser line accuracy < 40" (Arc Second) = $\frac{40}{3600}$ ° (Degree)

For VLM-635/650-37 Series, Laser line accuracy < 20" (Arc Second) = $\frac{20}{3600}$ ° (Degree)

For VLM-532-46 Series, Laser line accuracy < 20" (Arc Second) = $\frac{20}{3600}$ ° (Degree)