

Fast Axis Collimator Lenses (FACs) from prototype to serial production

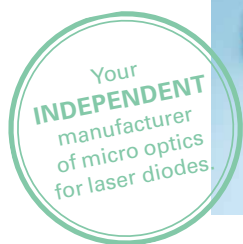

FISBA is a leading and independent supplier of FAC lenses in large quantities. Contact us for your next project regarding custom design, prototype development and large scale production.

Technical Data

- Focal length: 150 – 1700 μm
- Material: high index glass with $n > 1.8$
- Wavelength: 430 – 1550 nm
- Length: 2 – 20 mm

FISBA Capabilities

- Leading supplier of FACs in large quantities
- In-house custom design
- Prototype production
- Large scale production
- Customized FACs assembled to bottom tab

Your Benefits

- Independent supplier
- Customized coating design by FISBA
- Large portfolio of standard FAC lenses
- Fast ramp-up from prototype to serial production
- Packaging according to customer request
- We ensure FACs are never the limiting factor of your production scale-up

Industries & Applications

- Diode Laser Integration
- Optical Communications

Technical Specifications

Fast Axis Collimator Lenses (FACs)

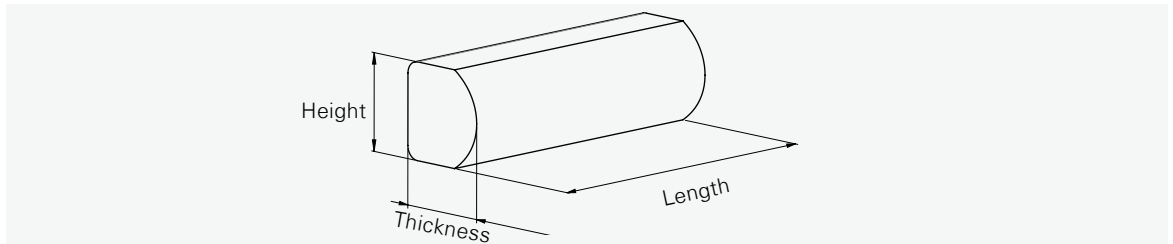

Parameters	Wavelength range	Numerical aperture	Focal length		Back focal length		Residual divergence		Dimension (height x thickness) mm
	nm		EFL μm	@ nm	BFL μm	@ nm	mrad*	@ % power enclosure	
FAC 150	790–990	0.8	150	940	30	940	±4.25	85	0.23 x 0.20
FAC 200	790–990 750–850	0.8	200	940 808	55 54	940 808	±3.00	85	0.33 x 0.27
FAC 300	790–990 750–850 515–705	0.8	300 300 290	940 808 638	70 68 65	940 808 638	±2.50	85	0.50 x 0.43
FAC 310	430–470	0.75	310	450	75	450	±2.25	85	0.50 x 0.41
FAC 360	790–990	0.8	360	940	70	940	±2.00	85	0.60 x 0.53
FAC 360	1450–1550	0.8	370	1470	74	1470	±3.13	85	0.60 x 0.53
FAC 450	790–990	0.8	450	940	100	940	±1.60	85	0.75 x 0.64
FAC 510	790–990	0.8	510	940	116	940	±1.50	85	0.90 x 0.71
FAC 600	790–990	0.8	600	940	120	940	±1.20	90	1.00 x 0.866
FAC 600	790–990 620–750	0.5	600 590	900 670	150 131	900 670	±1.50	85	0.80 x 0.82
FAC 600	430–470	0.8	600	450	140	450	±1.50	85	1.00 x 0.83
FAC 740	790–990	0.8	740	940	70	940	±1.25	85	1.20 x 1.22
FAC 900	790–990	0.8	900	940	90	940	±1.00	85	1.60 x 1.49
FAC 940	790–990	0.8	940	940	201	940	±0.95	90	1.50 x 1.34
FAC 1100	790–990	0.7	1100	940	110	940	±0.80	85	1.50 x 1.77
FAC 1100	790–990	0.45	1100	940	152	940	±0.95	85	1.10 x 1.72
FAC 1300	790–990	0.7	1300	940	130	940	±0.50	85	1.80 x 2.12
FAC 1500	790–990	0.5	1500	940	90	940	±0.55	85	1.65 x 2.58
FAC 1500	790–990	0.7	1500	940	90	940	±0.55	85	2.00 x 2.57
FAC 1700**	620–750 470–550 430–470	0.6	1690 1680 1650	630 520 450	1150 1130 1100	630 520 450	±0.75	85	2.63 x 1.24
All FAC	Length (mm): customized to your request								

* Measured at NA 0.29

** Design optimized for sources in TO package. BFL excluding 90 μm shift due to cover glass.

Customized designs available upon request